



Brisbane Central Business District Bicycle User Group

CBD BUG

GPO Box 2104,

Brisbane 4001

brisbanecbdebug@gmail.com

<https://www.facebook.com/cbdebug/>

The Right Honourable Cr Adrian Schrinner
Lord Mayor of Brisbane
GPO Box 2287
BRISBANE QLD 4001

Via email to: lord.mayor@brisbane.qld.gov.au

Dear Lord Mayor

The Brisbane CBD Bicycle User Group (CBD BUG) is writing to you regarding the recent announcement by Cr Ryan Murphy that CityLink will now extend down Melbourne St. The CBD BUG has a strong desire to ensure that the design is as appealing and safe as possible for users and we provide our comments to assist in this goal.

We would like to state the CBD BUG is very much in support of the roll out of safe, protected bike lanes through Brisbane that are well connected and link residents with key locations. Since Cr Murphy's announcement we have been unable to locate any drawings or schematic plans on the Brisbane City Council website in relation to this corridor. We have therefore reviewed the drawings of this project that the former MP for South Brisbane had uploaded to their webpage. Following review of these documents we have concerns regarding some aspects of the proposed design which are explained in detail below.

Melbourne St - Edmondstone St intersection.

The CBD BUG has concerns that the layout of this intersection will result in conflict or confusion between people traveling by walking and those on wheels. As can be seen in our mark up of the proposed layout (page 3 of this letter) pedestrians and bike or scooter riders will cross each other's paths. This has a high potential for conflict to occur - especially if any person is rushing to cross the intersection before the change of lights. The bicycle travel path is also uncomfortably close/ intersects with the landing zone of the proposed kerb ramps. While we understand the documents we are reviewing may be out of date, the released artistic image does show a buildout in place of a continuous bike lane.



Option 1 (page 3 of this letter)

As per the CityLink Cycleway bike lanes in the CBD, the bike lanes should be continuous through the intersection. Re-align the bike lanes by pushing them back 2 metres from the travel lane. This will give an improved buffer away from general motor vehicle traffic. This design removes all interactions between people on foot and wheels as the intersection is light controlled with wheeled movements being set back away from the pedestrian crossing point. Disability Discrimination Act access is maintained at the intersection as per AS1428.1.

Option 2 (page 4 of this letter)

As per the CityLink Cycleway bike lanes in the CBD, the bike lanes are continuous through the intersection. Re-align the bike lanes by pushing them back 1 metre from the travel lane. This will give an improved buffer from general motor vehicle traffic. This design removes all interactions between people on foot and two wheels as the intersection is light controlled with wheeled movements being set back from the pedestrian crossing point. Disability Discrimination Act access is maintained at the intersection as per AS1428.1.

Melbourne St - Boundary St intersection (page 4 of this letter)

As has been observed on the Gabba Bikeway it is not uncommon for people driving motor vehicles to not adhere to road rules when it comes to crossing cycleways. This is especially the case when the road layout is similar to a "slip lane" in its geometry. For this reason we see a real risk of a person on a bike being impacted by a motorist when travelling across this intersection. For this reason we suggest a raised priority crossing in this location to lower the speed of motorists at this intersection.

As stated at the beginning of this letter the CBD BUG strongly supports the extension of the CityLink Cycleways into West End. Protected bike lanes are the key to encouraging and supporting people to jump on a bike to travel about - but they have to be well designed to be safe and free from potential conflict with other road users.

The CBD BUG looks forward to your reply.

Yours sincerely



Donald Campbell
Brisbane CBD BUG
17th December 2024

CC: Bicycle Queensland
Space for Cycling Brisbane
Queensland Walks
Members of BCC Public and Active Transport Committee
| Cr Trina Massey Councillor for The Gabba
Dr Barbara O'Shea Member of South Brisbane

CBD BUG PROPOSED AMENDMENTS

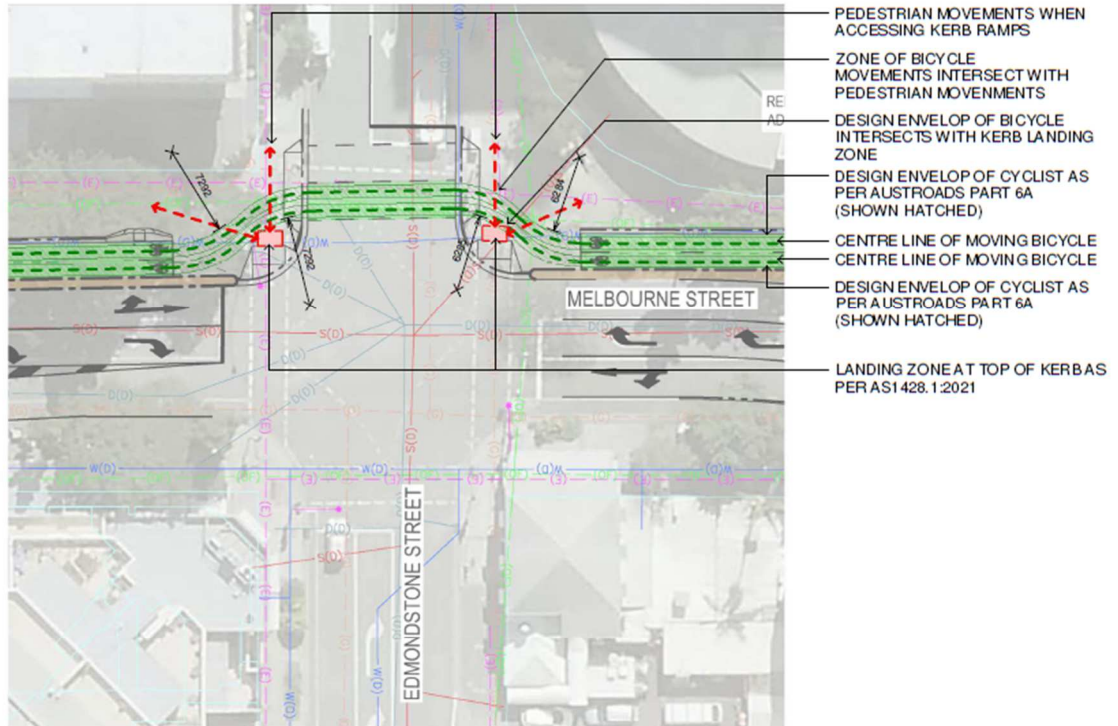

1 EXISTING BCC PROPOSAL
1 : 250

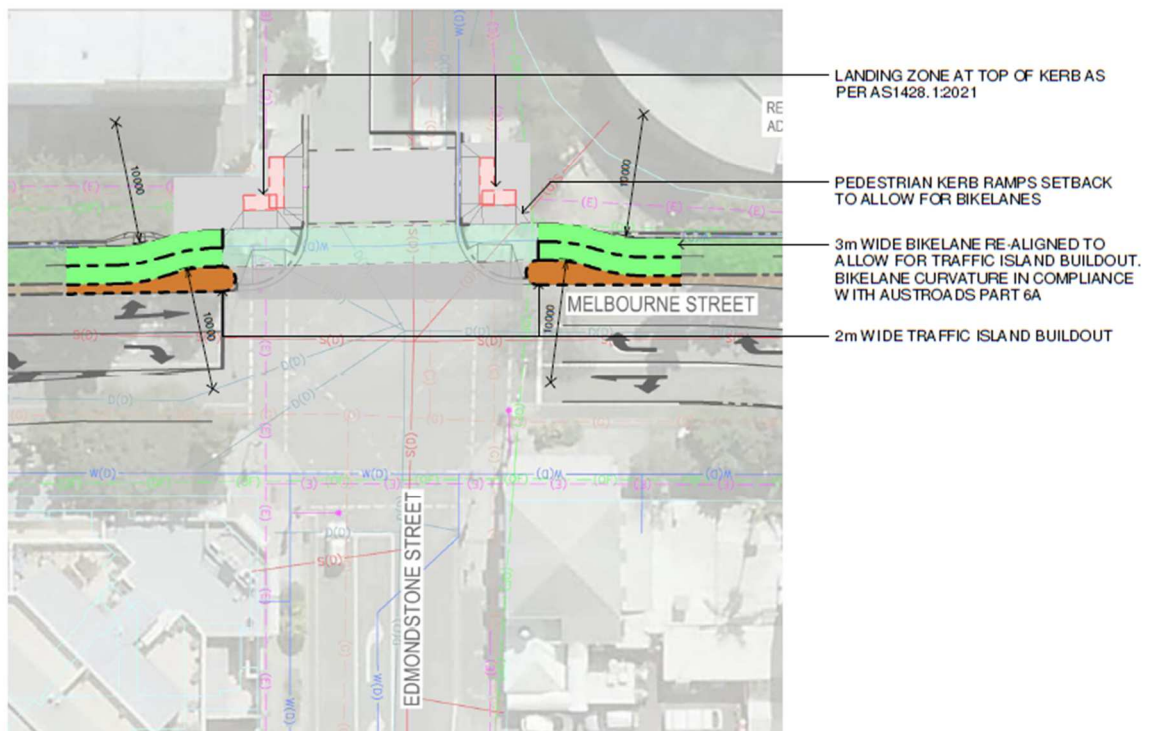

2 PROPOSED AMENDMENTS - OPTION 1
1 : 250

CBD BUG, PROPOSED AMENDMENTS

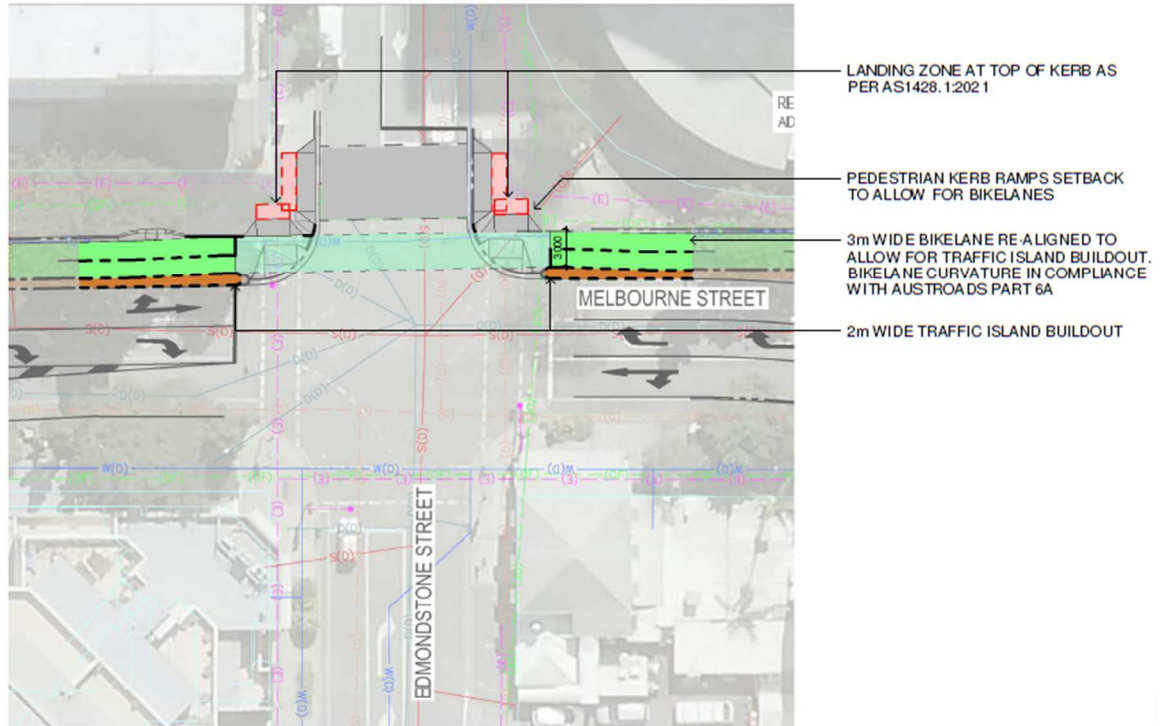

1 PROPOSED AMENDMENTS - OPTION 2 1 : 250

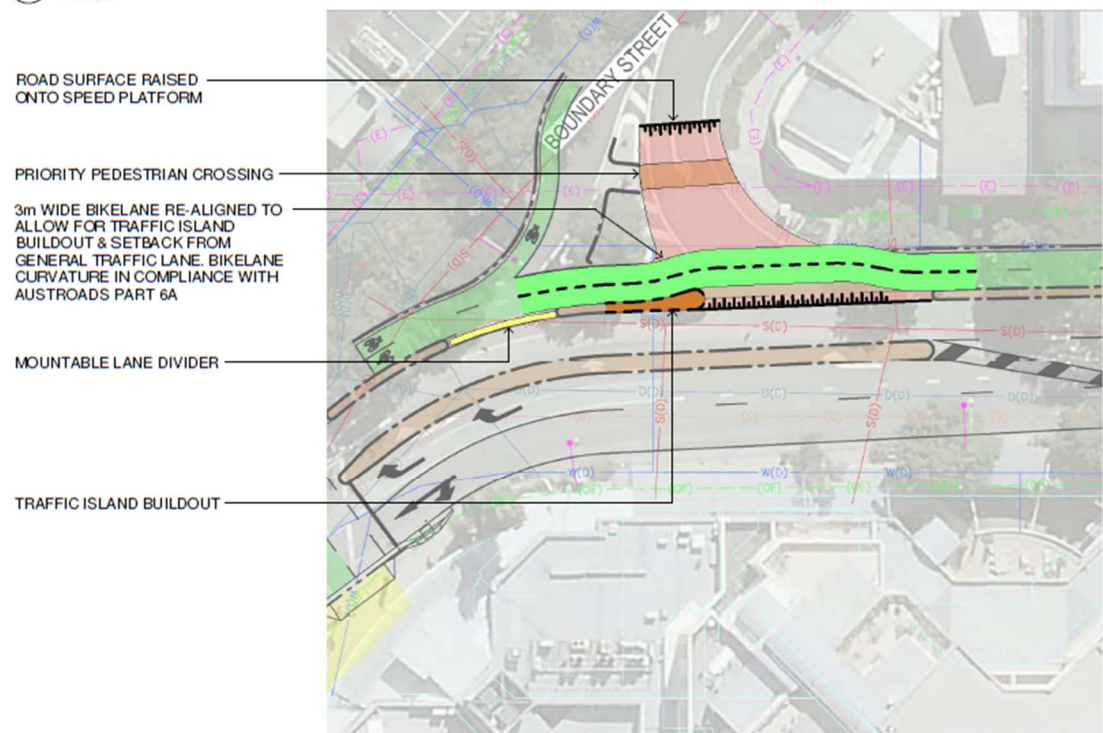

2 PROPOSED AMENDMENTS - MELBOURNE BOUNDARY 1 : 250